

REAL ESTATE DEPT RECORD

DRAWER.....ATLAS 5^W ROLL MAP.....MAP 45
CASE NUMBER.....51753

SECTION 32
SECTION 33
3

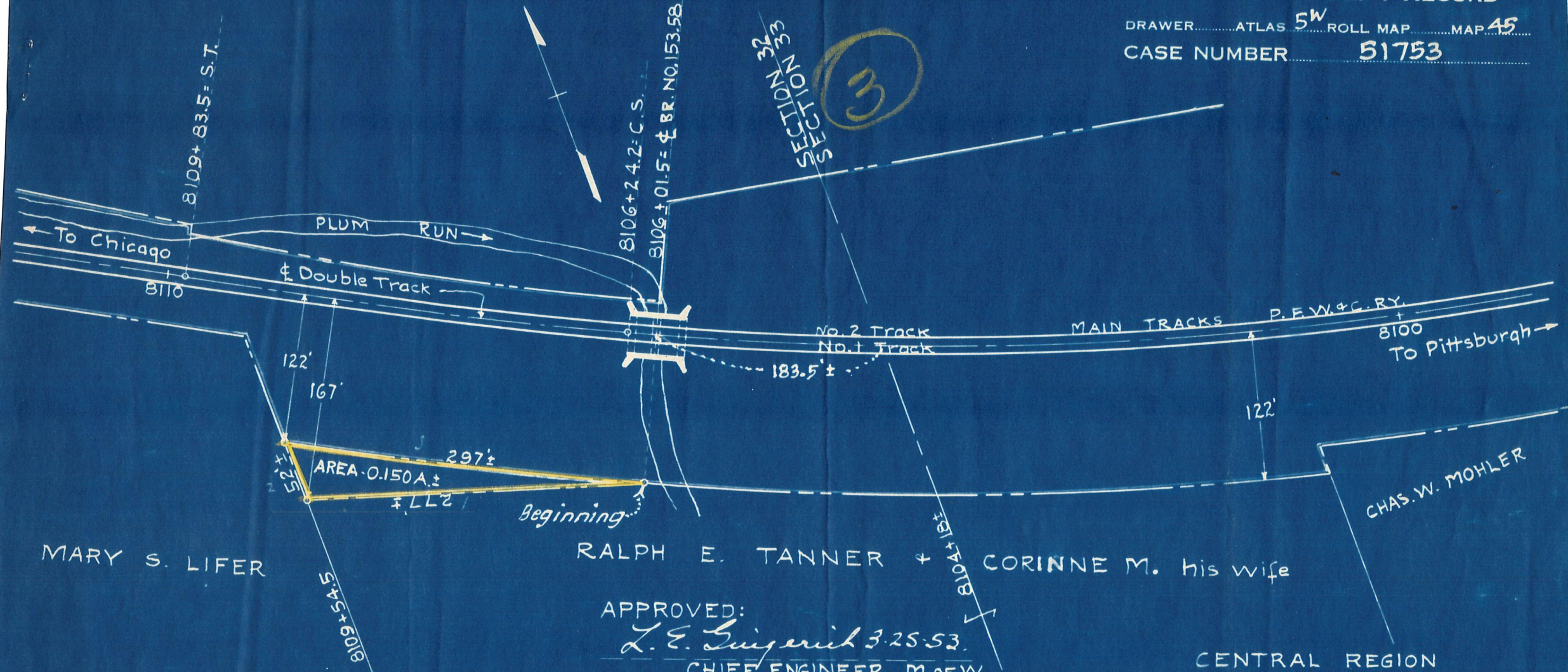

MARY S. LIFER

RALPH E. TANNER + CORINNE M. his wife

CHAS. W. MOHLER

APPROVED:
L. E. Guiguerik 3-25-53.
CHIEF ENGINEER M.O.F.W.

CENTRAL REGION
EASTERN DIV. MAIN LINE
Property to be Acquired From
RALPH E. TANNER + CORINNE M. his wife
by
PITTSBURGH, FT. WAYNE + CHICAGO RY. CO.

LEGEND

RED OUTLINE - P.F.W. & C. RY. OWNERSHIP
BROWN OUTLINE - PROPERTY TO BE PURCHASED

LOCATION: EAST OF LOUDONVILLE, OHIO.
WARD..... CITY..... BOROUGH NE 1/4 SEC. 32 - T 20 N. - R 15 W
TOWNSHIP WASHINGTON COUNTY HOLMES STATE OHIO MAP - VI - O - No. 105

SCALE 1 IN = 100' DATE March 10, 1953
MADE BY J.C.G. JR. CHECKED BY.....