



THOMAS E. FERGUSON
AUDITOR OF STATE
COLUMBUS, OHIO 43216

DEPUTY AUDITORS:

JAMES A. BOLDEN
Administration

RICHARD G. NUSS
CPA
Auditing Division

RUSSELL ROUCH
Management Advising
Service

CERTIFICATION

I, Thomas Aquinas Burke, Supervisor, Land Office of the Auditor of State, duly authorized to perform the duties of the Auditor of State prescribed in Section 115.21 of the Ohio Revised Code, hereby certifies that the enclosed field notes and plats are true copies taken from records in our office. These plats and field notes are for the following townships in the United States Military District:

1. Range 4, Townships 8, 9 and 10
2. Range 5, Townships 8, 9, and 10
3. Range 6, Townships 8, 9, and 10
4. Range 7, Townships 8, 9, and 10
5. Range 8, Townships 8 and 9
6. Range 9, Townships 8 and 9

and in the Ohio River Survey

1. Range 11, Townships 14 and 15
2. Range 12, Townships 14 and 15
3. Range 13, Townships 13 and 14
4. Range 14, Townships 17 and 18
5. Range 15, Townships 19 and 20

Witness my hand and seal of the Office of the Auditor of State, at Columbus, Ohio, this Twentieth-Nine day of November in the year of Our Lord Ninteen Hundred and Eighty-Three (1983).

Thomas Aquinas Burke
Supervisor
State Land Office

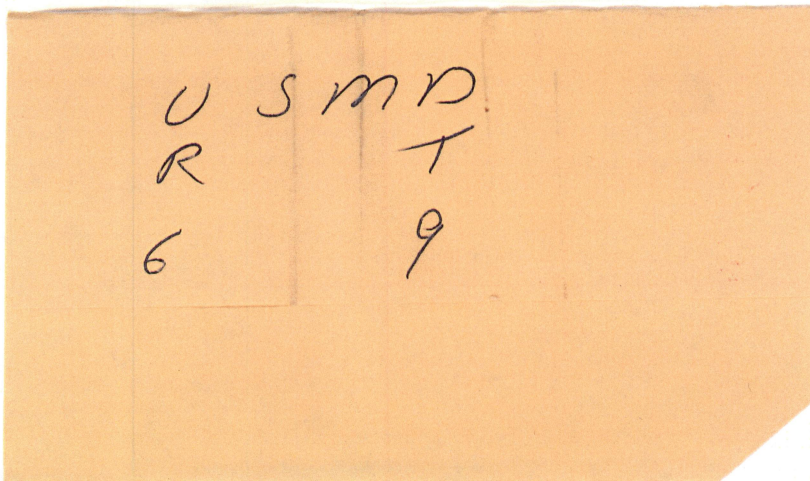

North boundary of Township N^o. 9 Range N^o. 6

From Northeast Corner of Town 9 and Southeast of Town

West -	10 Range 6 Run West
01..60	a forked white oak 2 1/2 feet diam -
22..45	a S° 15' E°
31..22	" S° 16' E° Land good
	timber principally white oak
35..	Enter a marsh
42..53	an apple tree 12" diam - through the marsh wood with grass & ferns bearing N & S
53..20	a white oak 14" diam
67..46	a S° 14' E° Land good -
84..75	a small spring brook running S 20 ^o W Land Rich
89..00	a white oak 20" diam
89..07	a S° 16' E°
99..24	a Hickory 12" diam - Rich Land timber white oak oak Hickory Chestnut & sassafras
109..34	a white oak 16" diam
117..71	a Black ash 12" S°
119..	over a small brook running S 30 ^o W
123..61	an ash 16" diam
144..	an Elm 12" S°
147..20	a brook 20 links wide running N & W supposed to be a branch of Sugar Creek
154..50	a white oak 12" diam
163..	a brook 10 links wide running N 20 ^o W
177..30	a white oak 13" diam - good bottom land for east N & W timber white oak black oak Maple &c

North boundary of Township No. 9 Range No. 6 cont

West
 188.. 2
 192.. 00
 200..
 211.. 32
 211.. 32
 21.. 43
 19.. 40
 21.. 50
 30.. 04
 52.. 69
 72.. 37
 84.. 12
 101.. 03
 108.. 03
 120.. 60
 147.. 03
 151.. 15
 155.. 50
 160.. 69

a White Oak 12" diam -
 " small brook running North
 set Post corner to sections No. 122 Town 9
 & 3 & 4 Town 10 Range 6 - a White Oak 15" diam -
 bears N 25 W 36 links & a Hickory 18" diam - bears
 S 36 1/2 E 38 links Marked per plan
 2 1/2 Miles West
 a White Oak 14" diam -
 a Maple 12" ⁹⁰
 a Red Oak 14" diam Land somewhat broken soil = ^(= good)
 a small brook running N.E.
 a Black Oak 2 1/2 feet diam -
 a White Oak 13" diam Land somewhat stony
 & broken for last 15 chains soil good timber
 white & black oak Hickory & Chestnut
 a gum 12" diam Rich level Land for last
 8 chains timber white & black oak Chestnut & G.
 a white oak 18" diam Rich Land timber bush
 poplar white & black oak Hickory & C.
 a poplar 12" diam -
 a white oak 2 feet diam -
 a poplar 16" diam -
 poplar 2 1/2 feet diam - Land still good timber
 white & black oak Hickory poplar & some S. Walnut
 a small brook running N.W.
 a spring running North
 set a post at intersection of Matthew's line
 North of his corner - u Continued to page 143 -

A Poplar 18" diam - bears S 69 E 80 links Marked
S 2, T 9, R 6 - and a white oak 2 1/2 feet diam -
Marked S 3, T 10, R 6 N 32 E 6 links - and other
Marked per plan A

Description of Township No. 9 Range No. 6

Corner Posts bearings trees &c				Distances quality of the Land &c
Yr. of Wood	Inches diam eter	Course they bear	Links distant	
White Oak	30	N 32 E	6	From A to B Land good except the last half mile is some what stony & broken timber Oak Hickory Chesnut, Gum, Beech Poplar &c
Poplar	18	S 69 E	8	
White Oak	15	N 25 W	36	from B to C fine farming land except a marsh swamp, timber, Oak, Hickory Chesnut sassafras &c
Hickory	18	S 36.30 E	38	
White Oak	16	N 17.30 W	13	from C to D some good upland & bottom with flag & marshy swamps, timber, Oak, Chesnut, sugar tree Cherry, aspens &c
D.	14	N 40 E	13	
White Oak	36	S 16.30 W	41	from D to E first half rich soil but stony remainder good farming land timber Oak Hickory Cherry Plum &c
D.	16	N 26 E	57	
White Oak	20	N 6 E	35	from E to F tolerable good farming land in general rather stony in places timber, Oak, Hickory Chesnut, some poplar &c
D.	16	S 17.30 E	57	
Red Oak	30	N 54 E	37	from F to G rich Stony hills timber, Oak Hickory, Maple, Elm &c
Lynn	15	N 5 E	32	
Maple	14	N 49 W	36	from G to H hill Land of middle quality timber mostly Oak
Hickory	16	S 34.30 W	16	
Black Oak	17	S 36 W	57	from H to A very fine hill land for cultivation timber white Oak Hickory &c
White Oak	26	N 24.20 W	03	

This post stands 13 links North of the point of Intersection or true corner

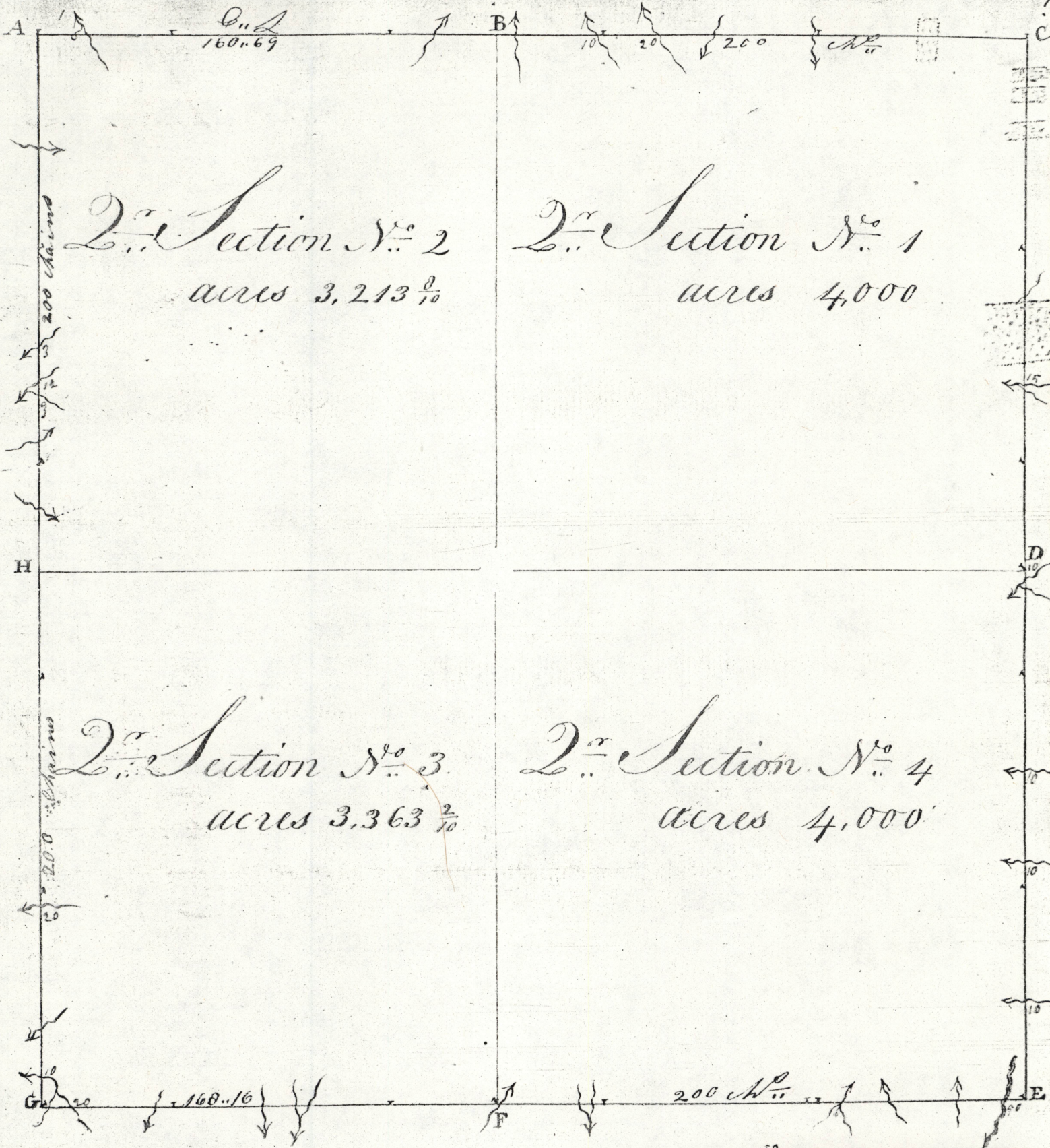

TOWNSHIP N^o. IX }
 RANGE N^o. VI } MILITARY DISTRICT.

50
 SCALE of Fifty Chains to an Inch